

THIS COPY IS PROVIDED ON A RESTRICTED BASIS AND IS NOT TO BE USED IN ANY WAY DETRIMENTAL TO THE INTERESTS OF PANDUIT CORP.

| PANDUIT<br>PART NUMBER | STUD<br>SIZE | DIMENSIONS in. |               |               |                |               |
|------------------------|--------------|----------------|---------------|---------------|----------------|---------------|
|                        |              | A $\pm .03$    | W $\pm .01$   | C $\pm .02$   | M $\pm .03$    | H $\pm .01$   |
| PNF14-6LF              | #6           | .87<br>(22.10) | .25<br>(6.35) | .20<br>(5.08) | .65<br>(16.51) | .14<br>(3.56) |
| PNF14-6LFW             | #6           | .84<br>(21.34) | .29<br>(7.37) | .20<br>(5.08) | .65<br>(16.51) | .14<br>(3.56) |
| PNF14-8LF              | #8           | .93<br>(23.62) | .29<br>(7.37) | .25<br>(6.35) | .70<br>(17.78) | .16<br>(4.06) |
| PNF14-10LF             | #10          | .93<br>(23.62) | .33<br>(8.38) | .25<br>(6.35) | .70<br>(17.78) | .19<br>(4.83) |

NOTES:

- UL LISTED AND CSA CERTIFIED FOR:
  - 600V. MAX. BLDG WIRE  
(1000 V. MAX IN SIGNS, FIXTURES & LUMINAIRES),
  - #18-14 AWG SOLID OR STRANDED  
COPPER WIRE WITH THE CT-550, CT-500, CT-1550, CT-1551  
CT-460 (UL ONLY) AND CT-400 (UL ONLY) INSTALLATION TOOLS.
  - #16-14 AWG SOLID OR STRANDED  
COPPER WIRE WITH THE CT-100  
AND CT-250 INSTALLATION TOOLS.
  - 221°F (105°C) MAX TEMP. RATING
- MATERIAL:
  - STAMPING - .032" (.81) THK COPPER, TIN PLATED
  - HOUSING - NYLON, BLUE
  - SLEEVE - BRASS, TIN PLATED
- STRIP LENGTH - 7/32  $\pm 1/32$ <sub>0</sub>
- PACKAGE QTY: -C=100  
-M=1000
- DIMENSIONS IN BRACKETS ARE IN MILLIMETERS

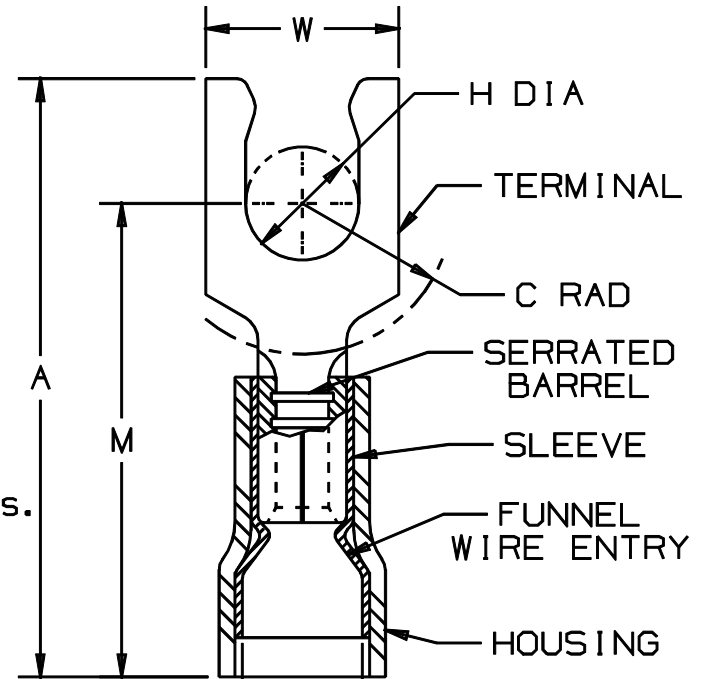

.162 (4.11)  
MAX. WIRE  
INSUL. DIA.  
.080 (2.03)  
MIN. WIRE  
INSUL. DIA.



LISTED  
587H  
E52164



CERTIFIED  
LR31212

A41294\_07

|     |       |      |     |   |       |      |     |  |              |                       |                       |
|-----|-------|------|-----|---|-------|------|-----|--|--------------|-----------------------|-----------------------|
| 7   | 1/01  | RM   |     | FILESPEC WAS N41294AA_PCD_06                        |       |      |     |  | CORP.        | TINLEY PARK, ILLINOIS |                       |
| 6   | 12-96 | JAMB |     | ADDED DIM. "MIN. WIRE INSUL. DIA."<br>UPDATED NOTES | 05386 |      |     |  |              |                       |                       |
| 5   | 3-95  | MS   | RLS | UPDATED NOTES AND DIMENSIONS                        | 03049 | LA   | KRS | #16-14 BARREL NYLON INSULATED LOCKING<br>FORK, FUNNELED WIRE ENTRY, .162 (4.11)<br>MAX. WIRE INSULATION DIAMETER |              |                       |                       |
| 4   | 8-88  | DW   |     |   |       |      | JB  |  |              |                       |                       |
| REV | DATE  | BY   | CHK | DESCRIPTION   | ECN # | CUST | PM  | DRAWN BY<br>DW   | CHK'D<br>RLS | SCALE<br>NONE         | DRAWING NO.<br>A41294 |